

Type	No.	Material	Colour	Weight	Mesh size	Roll size	UV resistance	Fire rating
Grip mesh	GG2	MDPE	White	430 g/m ²	1.8 x 2.4 mm	Width: 100 cm, length: 50 m	Yes	B
	GG3	PVC	White	300 g/m ²	1 x 2 mm	Width: 120 cm, length: 50 m	Yes	B

Placement options

No rights can be derived from the drawings.

- Grip mesh GG3 for roof access:** Grip mesh GG3 is suitable for use on roof structures and is rolled out over the roof before counter battens and tile battens are installed. The flexible fibre structure follows irregularities in the roof decking. Because GG3 is flexible, the grip mesh can also be placed over the counter battens. In this case, the mesh must be fixed on both sides of the counter battens. If the entire roof is not to be covered with grip mesh, a strip of approx. 1 m along the outer edge of the roof may also be used. The rest of the roof can be screened off with bird and bat eaves combs (VMS1).

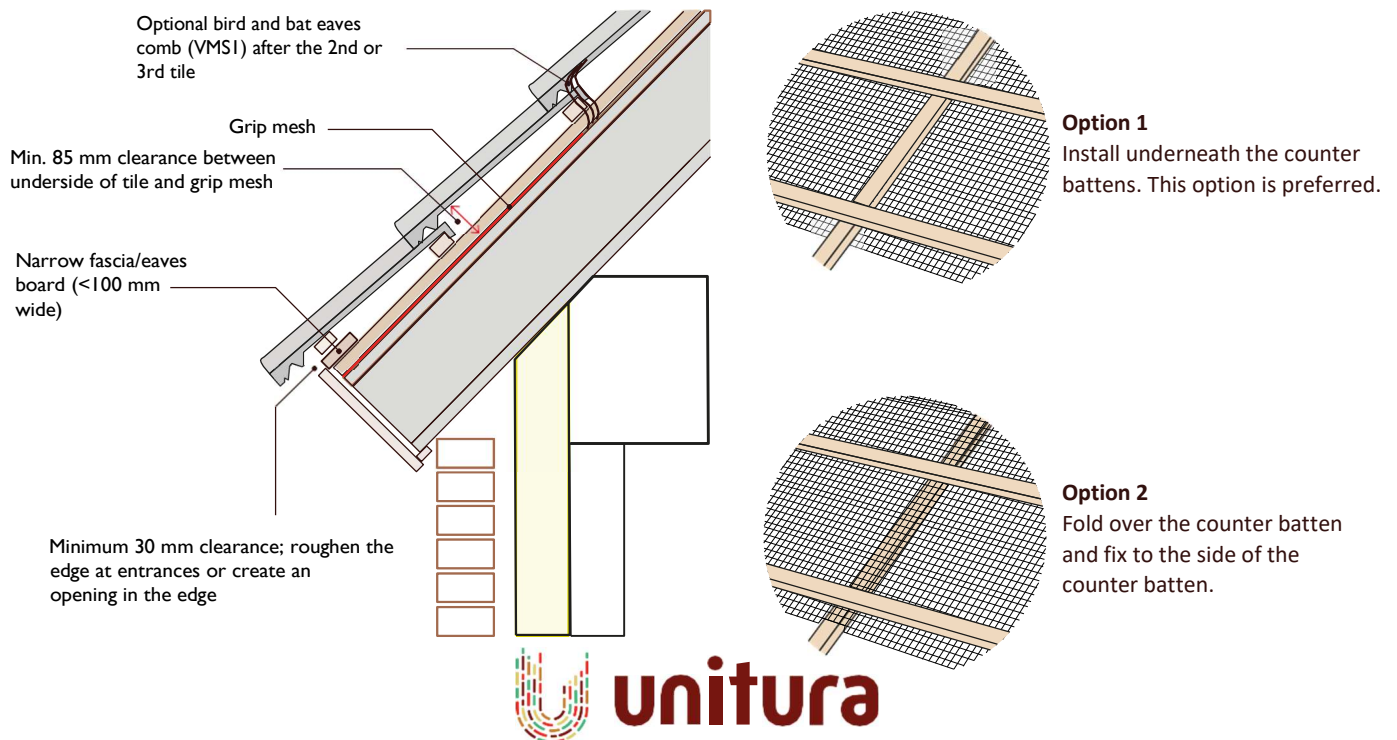

- 2** Grip mesh GG2 for cavity wall access: Cavity walls and intermediate cavity walls can be made accessible to bats using an entrance brick or intermediate-cavity wall entrance. If insulation material is used, it must be covered with grip mesh. The grip mesh protects vulnerable layers from damage while also giving species sufficient grip to use the cavity walls effectively as a roost. It is recommended to make as much as possible of the cavity wall available to bats. The grip mesh must be fixed with insulation fixings.

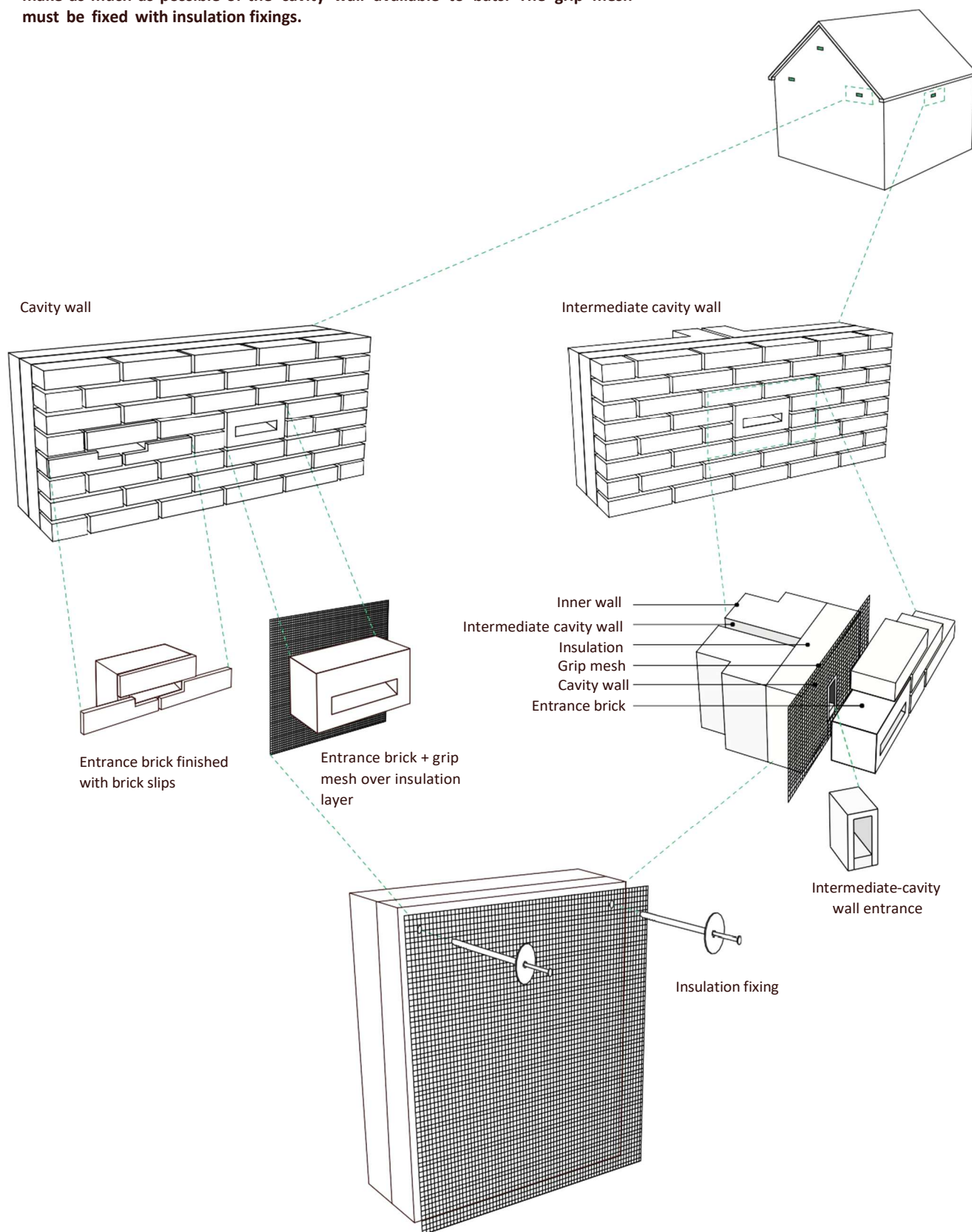

Additional advice and maintenance



Project-specific requirements and the Dutch Decree on Buildings in the Living Environment (Bbl)

Project-specific requirements and the guidelines of the Dutch Decree on Buildings in the Living Environment (Bbl) must be followed at all times.



Construction

Specific situations, building systems or prefabricated structures must always be handled in consultation with, and on the advice of, the manufacturer and the project-specific consultant. This includes advice on construction, fire safety and building physics.



Inspection and repair

Check for any damage to and around the provision. Repair any damage.