

BZP1

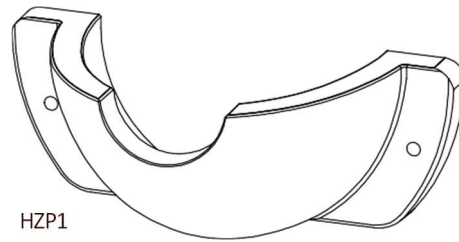

HZP1

Type	No.	Material	Weight	Entrance	External dimensions	Internal dimensions (L x W x H)	Components
Barn swallow	BZP1	Woodcrete	0.59 kg	-	23 x 12 x 9.7 cm	14.8 x 10.4 x 8.1 cm	incl. 2 screws
House martin	HZP1	Woodcrete	0.56 kg	64x28 mm	23 x 11.5 x 9.7 cm	14.8 x 9.8 x 8.1 cm	incl. 2 screws

### Installation step-by-step plan

#### A Barn swallow:

Install the nest cup directly beneath ceiling. Ensure that there is a small gap of at least 4 cm between the ceiling and the edge of the nest cup. A minimum distance of 1 metre between nest cups is recommended. Occupation is most likely in locations near livestock.

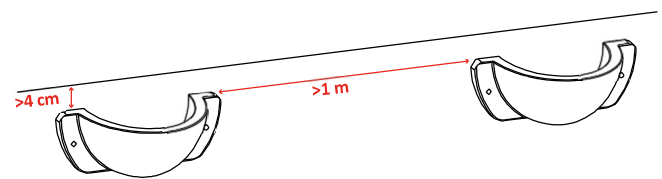

#### B House martin:

Install the nest cup directly under an overhang. The nest cup can also be installed under a sloping overhang. Ensure that the nest cup is not in full sun. It is preferable to place several nests close together so that house martins can nest in colonies.

#### B

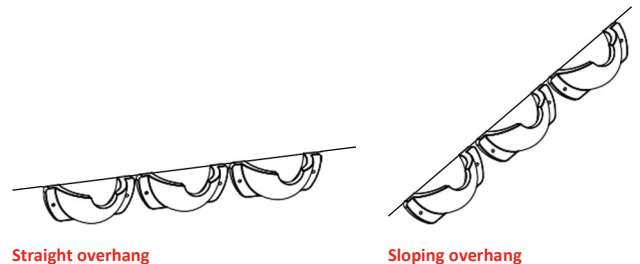

#### 1 Installation:

1. Mark the position of the two holes on the external wall
2. Drill 2 holes in the external wall with a masonry drill bit (6 mm) (not in the joints)
3. Install the nest cup using the supplied screws\*

\*Wall plugs are not required

\*Do not overtighten the screw, otherwise the screw may lose grip and the nest cup may break.

\*This assumes installation on masonry or mineral walls.

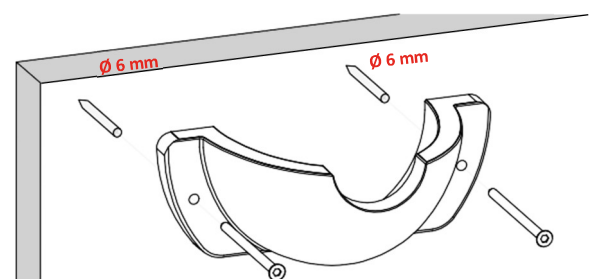



### **Project-specific requirements and the Dutch Decree on Buildings in the Living Environment (Bbl)**

Project-specific requirements and the guidelines of the Dutch Decree on Buildings in the Living Environment (Bbl) must be followed at all times.



### **Construction**

Specific situations, building systems or prefabricated structures must always be handled in consultation with, and on the advice of, the manufacturer and the project-specific consultant. This includes advice on construction, fire safety and building physics.



### **Inspection and repair**

The provision must be inspected once every 2 years. Check for cracking and any other damage to and around the provision. Also check the water-repellent coating. Repair any damage and touch up the water-repellent coating.